

HEMA Rotatorer

GIR models from Baltrotor

The GIR models are available in several different variations with different SWL loads, ranging from 8-45 ton – and all rotate continuously.

The rotators are intended to be used where there are requirements for high carrying capacity, both vertically and horizontally, especially on machines used within industries dealing with metal and scrap, contractors and forestry contractors. Similarly, the rotators are also intended to be used on tools for demolition, cutting and sorting, as these have extreme loads.

The GIR rotators are also distinguished by their relatively low weight and physical size, while at the same time having a high torque. These features make the rotator applicable where high precision is required, for example, assembly tasks and dismantling work.

Their flexibility makes the rotators applicable when it comes to custom made products with regards to implementing the rotators on existing tools.

Please contact our sales department for correct selection of crane and tool link.

-Technical data on backside



Product nr. 3095 9380

GIR 12

8 til 25 Tons



INDUSTRIAL ROTATOR GIR 12

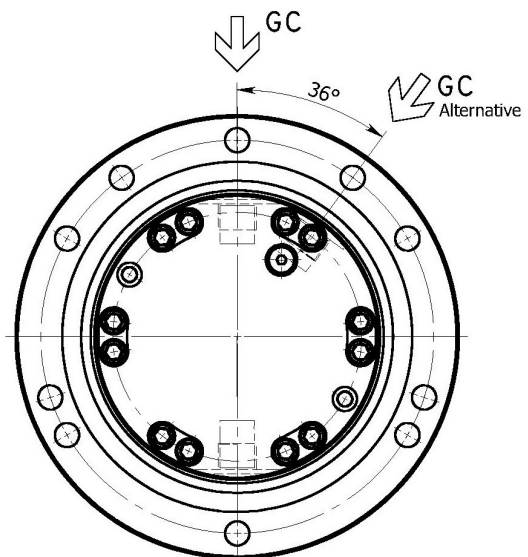
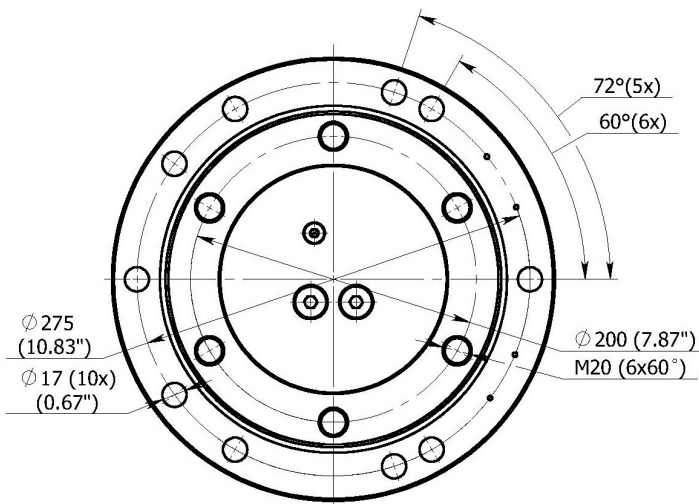
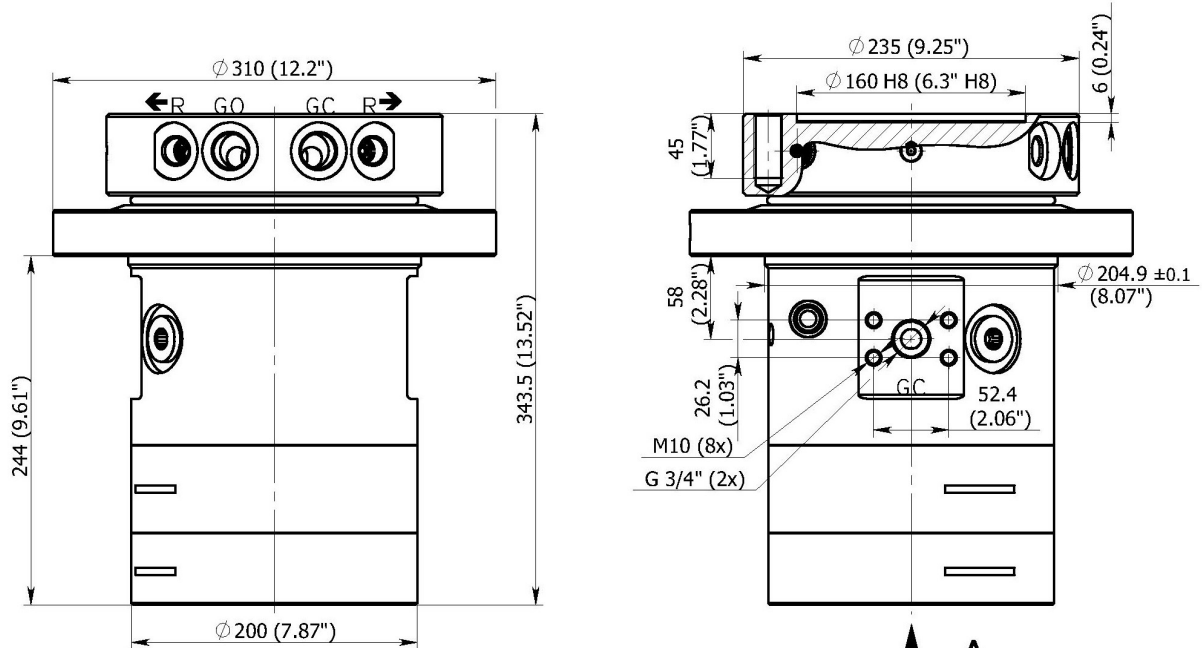

Technical data

Rotation	Unlimited
Max axial load static	± 250 KN (56202 lbf)
Max axial load dynamic	± 80 KN (17985 lbf)
Torque at 20 Mpa	1700 Nm (1254 lb ft)
Rated displacement	724 cm ³ /rev. (44.2 in ³ /rev.)
Rotation speed	max 30 rpm
Oil duct area for grapple	150 mm ² (0.232 in ²)
Weight	84 kg (185 lb)

Function	Max working pressure	Rec oilflow	Connection
R - rotation	21 MPa (3045 psi)*	25 l/min (6.6 gal(US)/min)	G 1/2"
GO - grapple/tool open	32 MPa (4640 psi)*		G 3/4", SAE 1"
GC - grapple/tool close	32 MPa (4640 psi)*		G 3/4", SAE 1"

* Relief valves fitted

↑ GO
↓ GC
↙ GC Alternative
VIEW A